



Schenectady County
Purchasing Department

620 State St.-2nd Floor
Schenectady, NY 12305
purchasing@schenectadycountyny.gov
518.388.4240

ADDENDUM

RFB-2024-57
GLENVILLE, NISKAYUNA, SCOTIA LIBRARIES INTERIOR RENOVATIONS

ADDENDUM #2

Issued Date: 09/19/2024

The purpose of this addendum is to provide detailed information to all Bidders. This addendum is hereby included in and made part of the Contract Documents, whether or not attached thereto. Receipt of this Addendum must be acknowledged on the bid form.

CONTENTS/RESPONSE TO QUESTIONS/REFERENCE TO ATTACHMENTS

General:

1. This addendum changes the documents for Bid #RFB-2024-57.

Attachments and Document Revisions:

1. Drawing A900B
 - a. Add note for WS-1 Window Shades location and requirement for 3% Openness.

Please acknowledge this addendum on your bid form.

END OF ADDENDUM #2

Finish Notes

1. **GENERAL:**
 - a. INTERIOR WALL AND CEILING FINISHES IN EXIT PASSAGEWAYS, CORRIDORS, AND ENCLOSURE FOR EXIT ACCESS STAIRWAYS SHALL BE CLASS B (26-75 FLAME SPREAD INDEX, 0-450 SMOKE-DEVELOPMENT INDEX) OR BETTER, WHEN TESTED IN ACCORDANCE WITH ASTM E84-2007 OR UL 723-2003
 - b. INTERIOR WALL AND CEILING FINISHES IN SPACES OTHER THAN THOSE NOTED ABOVE SHALL BE CLASS C (76-200 FLAME SPREAD INDEX, 0-450 SMOKE DEVELOPMENT INDEX) OR BETTER, WHEN TESTED IN ACCORDANCE WITH ASTM E84-2007 OR UL 723-2003
 - c. FLOOR FINISHES SHALL COMPLY WITH THE DOC FF-1 "PILL TEST" CPSC 160CFR PART 1630-2000
 - d. GC TO PROVIDE TOILET SIGNAGE AS REQUIRED BY THE IBC CHAPTER 11 (AS AMENDED BY THE STATE BUILDING CODE), TITLE 24 2016 CBC PART 2 VOLUME 1 SECTION 11B (OR AS AMENDED BY THE STATE ACCESSIBILITY CODE) AND IPC 403.4 (OR AS AMENDED BY THE STATE PLUMBING CODE). REFERENCE ACCESSIBILITY SHEET FOR GENERAL MOUNTING HEIGHTS AND LOCATIONS
 - e. REFERENCE LIFE SAFETY PLAN FOR NOTES RELATED TO COMBUSTIBLE MATERIALS AND PLTWOOD SUBSTRATES
2. **GENERAL WALL FINISH NOTES:**
 - a. WHERE EXISTING WALLS ARE TO BE RETAINED AND RE-USED, CONTRACTOR SHALL REPAIR, PATCH AND SAND WALLS AS REQUIRED TO MEET THE OWNERS INTENT AND ACCEPTABLE FOR INSTALLATION OF SPECIFIED FINISHES.
 - b. ALL WALLS SHALL BE TAPED AND FINISHED TO A LEVEL 4 STANDARD. IT IS THE RESPONSIBILITY OF THE GC TO INSPECT WALLS AS TAPING AND PATCHING OCCURS TO MEET THE LEVEL 4 STANDARDS AS OUTLINED IN BY THE GWB BOARD MANUFACTURER STANDARDS FOR LEVELS OF DRYWALL, GLASS MAT AND GYPSUM PANEL FINISH. IF THE OWNER FINDS A WALL TO BE UNSATISFACTORY - THE CONTRACTOR SHALL REPAIR THE WALL TO AN ACCEPTABLE LEVEL 4 STANDARD AT THE CONTRACTORS COST
 - FINAL APPEARANCE: NO MARKS OR RIDGES, READY FOR PRIMING
 - JOINTS AND INTERIOR ANGLES: MINIMUM OF 2 SEPARATE COATS OF COMPOUND ABOVE LEVEL 2 APPLICATION
 - ACCESSORIES & FASTENERS: THREE SEPARATE COATS OF COMPOUND
 - SURFACE: JOINTS FILLED AND SMOOTHED AGAIN, SHALL BE PRIMED WITH CGC FIRST COAT BEFORE PAINTING OR TEXTURING
 - c. PROVIDE CONTROL JOINTS IN WALLS WHICH EXTEND 30' OR GREATER IN LENGTH WITHOUT A JOINT. COORDINATE FINAL LOCATION WITH ARCHITECT.
3. **GENERAL PAINTING NOTES:**
 - a. PAINTS, COATINGS AND PRIMERS APPLIED TO INTERIOR WALL AND CEILINGS SHALL NOT EXCEED THE VOC CONTENT LIMITS ESTABLISHED IN GREEN SEAL STANDARD GS- 11 PAINTS, FIRST EDITION MAY 20, 1993.
 - FLATS 50 G/L
 - NON-FLATS 150 G/L
 - b. ANTI-CORROSIVE AND ANTI-RUST PAINTS APPLIED TO INTERIOR FERROUS METAL SUBSTRATES SHALL NOT EXCEED THE VOC LIMIT OF 250 G/L ESTABLISHED IN THE GREEN SEAL STANDARD GC-02, ANTI-CORROSIVE PAINTS, SECOND EDITION JANUARY 7, 1997
 - c. PROVIDE GRAY WALL PRIMER FOR DARK AND HEAVILY SATURATED COLORS
 - d. REFERENCE FINISH LEGEND FOR PAINT SELECTION SPECIFICATIONS
4. **FLOORING NOTES:**
 - a. CONCRETE FLOORS SHALL BE PREPPED PER RESILIENT FLOORING MANUFACTURER STANDARDS.
 - b. FLOORS SHALL BE FLASH PATCHED TO ALLOW FOR FLUSH TRANSITIONS BETWEEN DISSIMILAR MATERIALS.

FINISH SCHEDULE

Room Number	Room Name	Floor		North Wall			East Wall			South Wall			West Wall			Ceiling		Comments
		Material	Finish	Material	Finish	Base	Material	Finish	Base	Material	Finish	Base	Material	Finish	Base	Material	Finish	
100	COMMUNITY MEETING ROOM	SEE FINISH PLAN	SEE FINISH PLAN.	GWB	PT-1	RB-1	GWB	PT-1	RB-1	GWB	PT-1	WB-1	GWB	PT-1	RB-1	EXIST.	EXIST.	

FINISH LEGEND

Finish No.	Category	Manufacturer	Series Style Color	Size	Location
ACOUSTICAL CEILING PANELS					
ACP-1	ACOUSTICAL CEILING PANELS	TURF	CREASE VARIES (A,B,C,D) SEE REFLECTED CEILING PLAN. 01 SANDSTONE	24"X24"	COMMUNITY ROOM. SEE REFLECTED CEILING PLAN.
ACP-2	ACOUSTICAL CEILING PANELS	TURF	CREASE VARIES (A,B,C,D) SEE REFLECTED CEILING PLAN. M48 TRAVERTINE	24"X24"	COMMUNITY ROOM. SEE REFLECTED CEILING PLAN.
ACOUSTICAL WALL PANELS					
AWP-1	ACOUSTICAL WALL PANELS	TURF	CARVED WALL TILE MAZE OUTER LAYER: FADED DENIM, INNER LAYER: FADED DENIM	12"X12"	COMMUNITY ROOM. SEE ELEVATIONS.
AWP-2	ACOUSTICAL WALL PANELS	TURF	CREASE VARIES (A,B,C,D) SEE ELEVATION M01 SANDSTONE	24"X24"	COMMUNITY ROOM. SEE ELEVATIONS.
AWP-3	ACOUSTICAL WALL PANELS	TURF	CREASE VARIES (A,B,C,D) SEE ELEVATION M48 TRAVERTINE	24"X24"	COMMUNITY ROOM. SEE ELEVATIONS.
CARPET TILE					
CPT-1	CARPET TILE	SHAW CONTRACT	TEAMWORK COLLABORATION TILE CLEAR IMPACT	9"X36"	COMMUNITY ROOM. SEE FINISH PLAN.
LUXURY VINYL TILE					
LVT-1	LUXURY VINYL TILE	SHAW CONTRACT	ORIGIN 4338V INITIATE	5.66" X 47"	COMMUNITY ROOM. SEE FINISH PLAN.
PAINT					
PT-1	PAINT	SHERWIN WILLIAMS	ALABASTER	-	COMMUNITY ROOM. SEE ELEVATIONS.
PT-2	PAINT	SHERWIN WILLIAMS	FADED FLAXFLOWER	-	COMMUNITY ROOM. SEE ELEVATIONS.
RUBBER BASE					
RB-1	RUBBER BASE	TARKETT	DURACOVE COLOR TO BE SELECTED BY ARCHITECT	4"	SEE INTERIOR ELEVATIONS.
TRANSITION STRIP					
TR-1	TRANSITION STRIP	JOHNSONITE	SLIM LINE TRANSITIONS COLOR TO BE SELECTED BY ARCHITECT	-	COMMUNITY ROOM. SEE FINISH PLAN.
TR-2	TRANSITION STRIP	JOHNSONITE	WHEELED TRAFFIC TRANSITIONS COLOR TO BE SELECTED BY ARCHITECT	-	COMMUNITY ROOM. SEE FINISH PLAN.
WINDOW SHADES					
WS-1	WINDOW SHADES	DRAPER	MANUAL CLUTCH-OPERATED FLEXSHADE M SCREEN WITH 3% OPENNESS COLOR TO BE SELECTED BY ARCHITECT	VARIES. COORDINATE WITH WINDOW SIZE.	COMMUNITY ROOM. SEE ELEVATIONS.

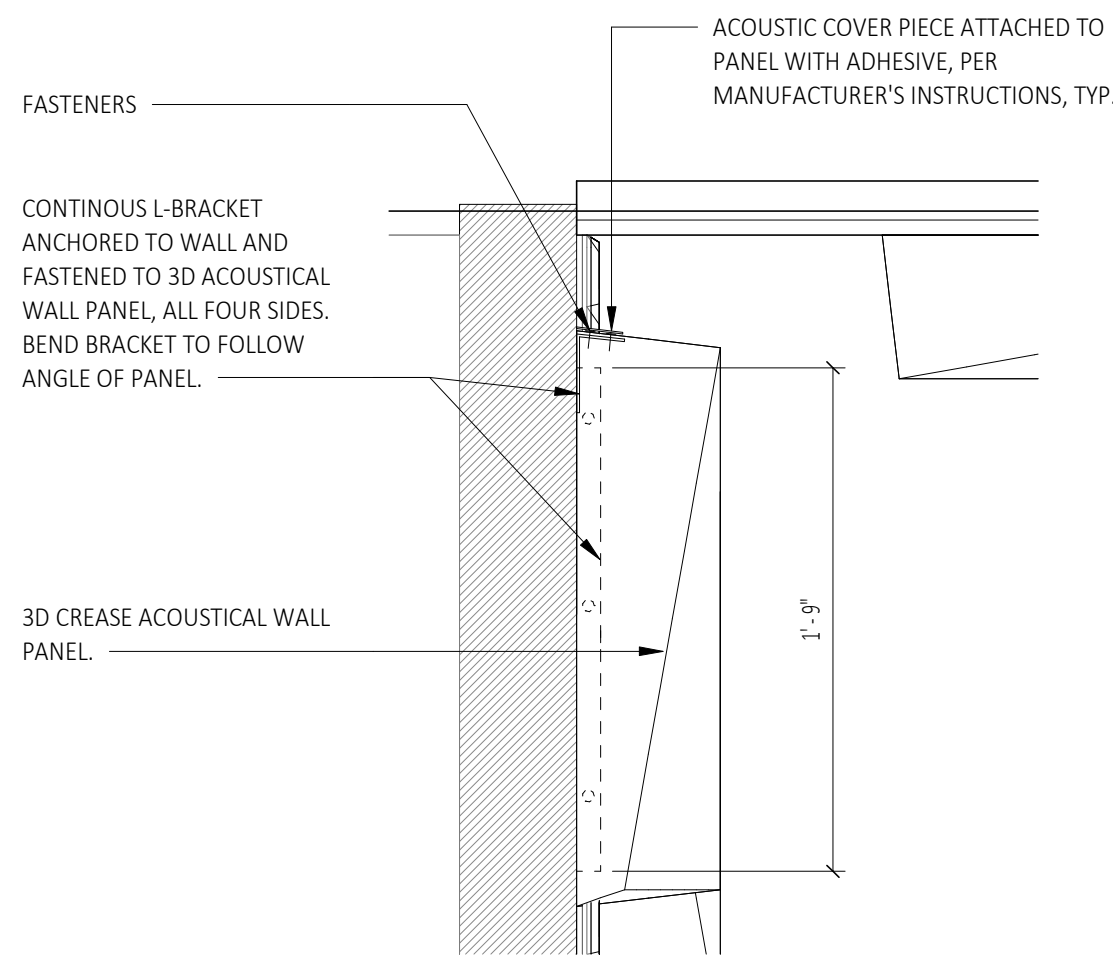

3 3D Acoustical Wall Panel Section

SCALE: 1 1/2" = 1'-0"

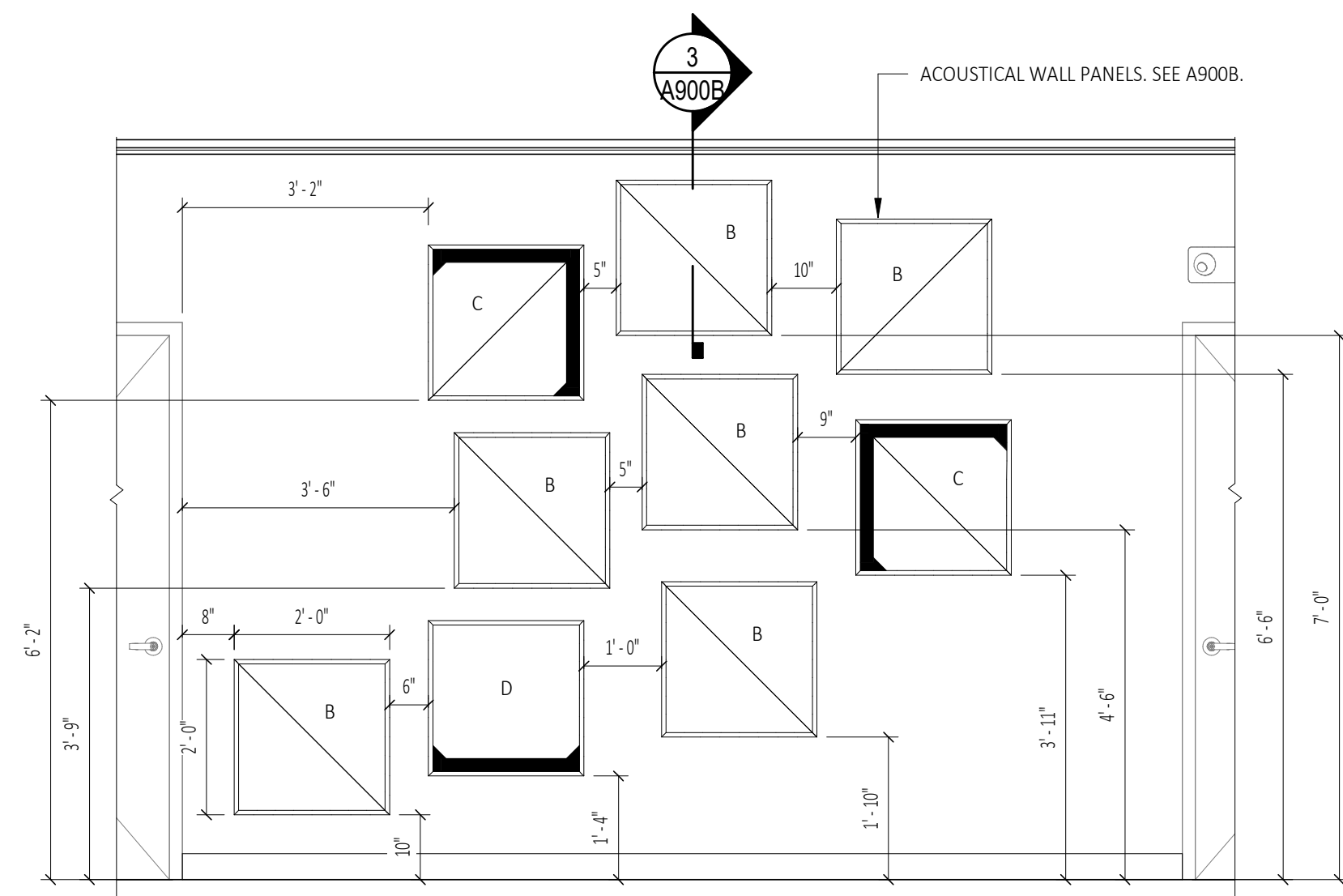

2 Acoustical Wall Panel Interior Elevation - Community Room (West)

SCALE: 1/2" = 1'-0"

1 First Floor Finish Plan

SCALE: 1/4" = 1'-0"

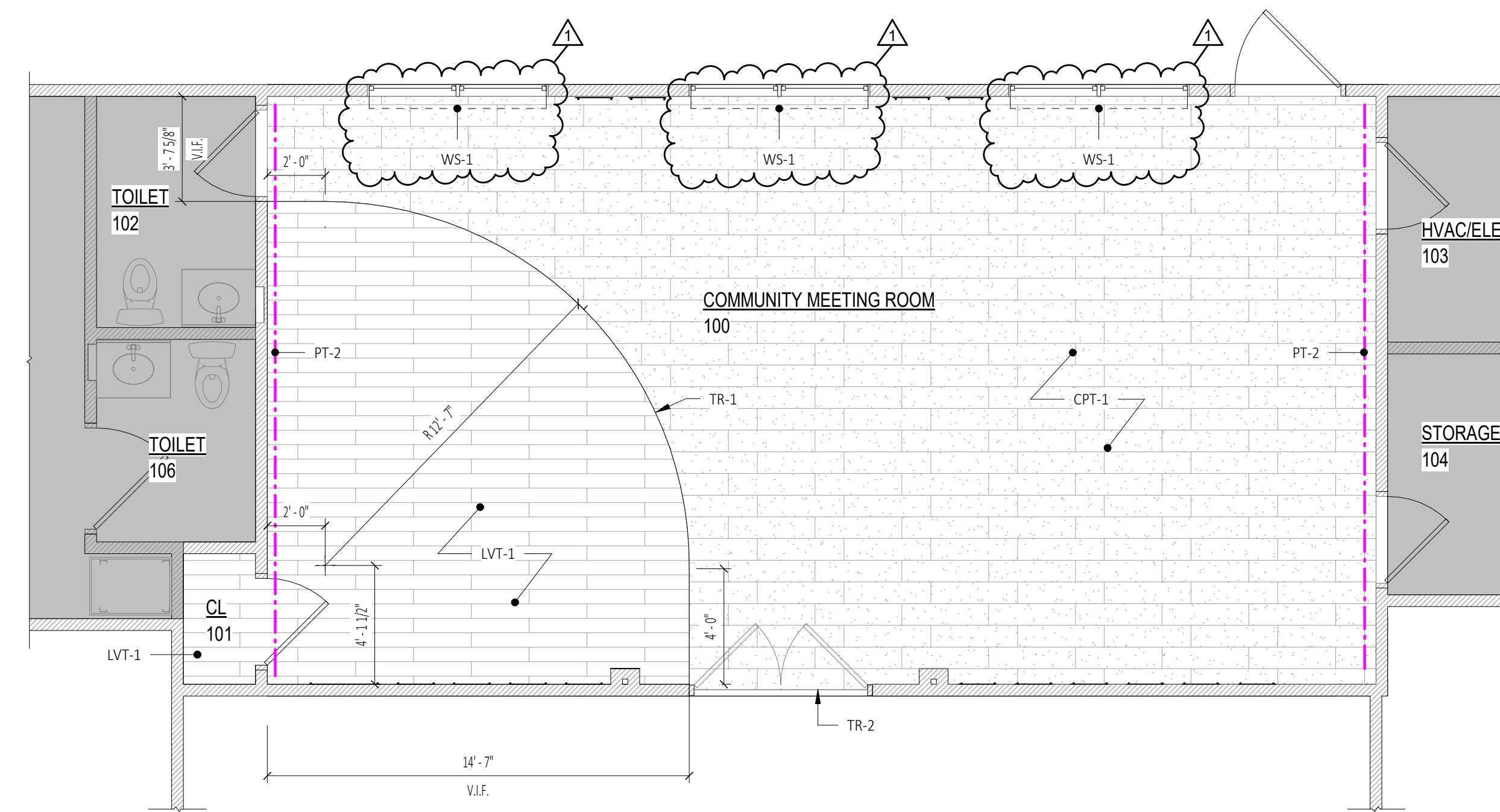

Owner:
Schenectady County
620 State Street
Schenectady, NY 12305

Architect:
C2 Architecture
24 Airport Road
Schenectady, NY 12302

MEP Engineer
Engineered Solutions
646 Plank Rd, Suite 104
Clifton Park, NY 12065

Stamp:

Project:
SCHENECTADY COUNTY
GLENVILLE, NISKAYUNA
& SCOTIA LIBRARIES
INTERIOR RENOVATIONS

Bid Set RFB-2024-57

No.	REVISION #	DATE:
1	Addendum #2	09/19/2024

Drawn By: C2 Architecture
Scale: As Noted
Date: 08/23/2024
Job No: 2409
Sheet Title:

NISKAYUNA - FINISH PLAN
AND SCHEDULE

Sheet Number:

A900B

